

Anchors Chain

STUD LINK CHAINS (JIS F-3303/1975)



Materials:
 Grade I Mild steel/SBC31-SS41B-S20C
 Grade II Special steel/SBC50
 Grade III Extra Special steel/SBC70

| Chain Dia (d) | Outside Length of Common Link (6d) | Outside Width of Common Link (3.6d) | Grade I | | Grade II | | Grade III | | Minimum Weight | | | Number of Links/25M | |
|---------------|------------------------------------|-------------------------------------|------------|---------------|------------|---------------|------------|---------------|------------------------------|--------------------------------|----------------------------------|---------------------|-----|
| | | | Proof Test | Breaking Test | Proof Test | Breaking Test | Proof Test | Breaking Test | kg/m (0.0219d ²) | kg/25m (0.5475d ²) | kg/27.5m (0.6023d ²) | | |
| m/m | | m/m | m/m | T | T | T | T | T | T | | | | pcs |
| 12.5 | 1/2 | 75 | 45.0 | | | 6.72 | 9.40 | - | - | 3.422 | 86.0 | 94.2 | 461 |
| 16 | 5/8 | 96 | 57.6 | 7.66 | 10.94 | 10.94 | 15.31 | - | - | 5.606 | 140.2 | 154.2 | 389 |
| 19 | 3/4 | 114 | 68.4 | 10.74 | 15.34 | 15.34 | 21.47 | - | - | 7.906 | 197.7 | 217.5 | 327 |
| 22 | 7/8 | 132 | 79.2 | 14.31 | 20.44 | 20.44 | 28.62 | - | - | 10.60 | 265.0 | 291.5 | 283 |
| 24 | 15/16 | 144 | 86.4 | 16.97 | 24.24 | 24.24 | 33.93 | - | - | 12.61 | 315.3 | 346.8 | 259 |
| (25) | 1 | 150 | 90.0 | 17.70 | 26.50 | 25.80 | 37.30 | - | - | 13.69 | 342.2 | 376.4 | 249 |
| 26 | 1 | 156 | 93.6 | 19.84 | 28.34 | 28.34 | 39.67 | - | - | 14.80 | 370.0 | 407.0 | 239 |
| 28 | 1 1/8 | 168 | 100.8 | 22.92 | 32.74 | 32.74 | 45.84 | - | - | 17.17 | 429.3 | 472.2 | 223 |
| 30 | 1 3/16 | 180 | 108.0 | 26.20 | 37.45 | 37.45 | 52.40 | - | - | 19.71 | 492.8 | 542.1 | 207 |
| 32 | 1 1/4 | 192 | 115.2 | 29.70 | 42.45 | 42.45 | 59.40 | - | - | 22.43 | 560.8 | 616.9 | 195 |
| 34 | 1 3/8 | 204 | 122.4 | 33.40 | 47.70 | 47.70 | 66.80 | - | - | 25.32 | 633.0 | 696.3 | 183 |
| 36 | 1 3/8 | 216 | 129.6 | 37.30 | 53.30 | 53.30 | 74.60 | - | - | 28.38 | 709.5 | 780.5 | 173 |
| 38 | 1 1/2 | 228 | 136.8 | 41.40 | 59.15 | 59.15 | 82.80 | - | - | 31.62 | 790.5 | 869.6 | 163 |
| 40 | 1 5/8 | 240 | 144.0 | 45.70 | 65.28 | 65.28 | 91.40 | 91.40 | 130.55 | 35.40 | 876.0 | 963.0 | 155 |
| 42 | 1 5/8 | 252 | 151.2 | 50.20 | 71.70 | 71.70 | 100.35 | 100.35 | 143.40 | 38.63 | 965.8 | 1,062.4 | 147 |
| 44 | 1 3/4 | 264 | 158.4 | 54.85 | 78.35 | 78.35 | 109.70 | 109.70 | 156.75 | 42.40 | 1,060.0 | 1,166.0 | 141 |
| 46 | 1 13/16 | 276 | 165.6 | 59.70 | 85.30 | 85.30 | 119.45 | 119.45 | 170.65 | 46.34 | 1,159.0 | 1,274.4 | 135 |
| 48 | 1 7/8 | 288 | 172.8 | 64.75 | 92.55 | 92.55 | 129.55 | 129.50 | 185.05 | 50.46 | 1,261.5 | 1,387.7 | 129 |
| 50 | 2 | 300 | 180.0 | 70.00 | 100.00 | 100.00 | 140.00 | 140.00 | 200.00 | 54.75 | 1,368.8 | 1,505.7 | 123 |
| 52 | 2 | 312 | 187.2 | 75.40 | 107.75 | 107.75 | 150.80 | 150.80 | 215.45 | 59.22 | 1,480.5 | 1,628.6 | 119 |
| 54 | 2 1/8 | 324 | 194.4 | 81.00 | 115.70 | 115.70 | 162.00 | 162.00 | 231.40 | 63.86 | 1,596.5 | 1,756.2 | 115 |
| 56 | 2 1/4 | 336 | 201.6 | 86.75 | 123.95 | 123.95 | 173.50 | 173.50 | 247.85 | 68.69 | 1,717.0 | 1,888.7 | 111 |
| 58 | 2 1/4 | 348 | 208.8 | 92.70 | 132.40 | 132.40 | 185.35 | 185.35 | 264.80 | 73.67 | 1,841.8 | 2,026.0 | 107 |
| 60 | 2 3/8 | 360 | 216.0 | 98.80 | 141.10 | 141.10 | 197.65 | 197.65 | 282.25 | 78.64 | 1,971.0 | 2,168.1 | 103 |
| 62 | 2 1/2 | 372 | 223.2 | 105.50 | 150.05 | 150.05 | 210.10 | 210.10 | 300.15 | 84.18 | 2,104.5 | 2,315.0 | 101 |
| 64 | 2 1/2 | 384 | 230.4 | 111.50 | 159.25 | 159.25 | 222.95 | 222.15 | 318.50 | 89.70 | 2,242.5 | 2,466.8 | 97 |
| 66 | 2 5/8 | 396 | 237.6 | 118.05 | 168.65 | 168.65 | 236.15 | 236.15 | 337.35 | 95.40 | 2,385.0 | 2,623.5 | 93 |
| 68 | 2 5/8 | 408 | 244.8 | 124.80 | 178.30 | 178.30 | 249.60 | 249.60 | 356.60 | 101.30 | 2,532.5 | 2,785.8 | 91 |
| 70 | 2 3/4 | 420 | 252.0 | 131.70 | 188.15 | 188.15 | 263.40 | 263.40 | 376.30 | 107.3 | 2,682.8 | 2,951.3 | 89 |
| 73 | 2 7/8 | 438 | 262.8 | 142.35 | 203.35 | 203.35 | 284.70 | 284.70 | 406.70 | 116.7 | 2,917.6 | 3,209.7 | 85 |
| 76 | 3 | 456 | 273.6 | 153.35 | 219.05 | 219.05 | 306.65 | 306.65 | 438.05 | 126.5 | 3,162.4 | 3,478.9 | 81 |
| 78 | 3 1/16 | 468 | 280.8 | 160.80 | 229.75 | 229.75 | 321.60 | 321.60 | 459.45 | 133.2 | 3,330.9 | 3,664.4 | 79 |
| 81 | 3 3/16 | 486 | 291.6 | 172.30 | 246.15 | 246.15 | 344.65 | 344.65 | 492.35 | 143.7 | 3,592.1 | 3,951.7 | 77 |
| 84 | 3 5/16 | 504 | 302.4 | 184.15 | 263.05 | 263.05 | 368.25 | 368.25 | 526.10 | 154.5 | 3,863.2 | 4,249.8 | 73 |
| 87 | 3 7/16 | 522 | 313.2 | 196.25 | 280.35 | 280.35 | 392.50 | 392.50 | 560.70 | 165.8 | 4,144.0 | 4,558.9 | 71 |
| 90 | 3 9/16 | 540 | 324.0 | 208.65 | 298.10 | 298.10 | 417.30 | 417.30 | 595.15 | 177.4 | 4,434.8 | 4,878.6 | 69 |
| 92 | 3 5/8 | 552 | 331.2 | 217.10 | 310.10 | 310.10 | 434.15 | 434.15 | 620.25 | 185.4 | 4,634.0 | 5,097.9 | 67 |
| 95 | 3 3/4 | 570 | 342.0 | 229.95 | 328.50 | 328.50 | 459.90 | 459.90 | 657.00 | 197.6 | 4,941.2 | 5,435.8 | 65 |
| 98 | 3 7/8 | 588 | 352.8 | 243.10 | 347.30 | 347.30 | 486.20 | 486.20 | 694.55 | 210.3 | 5,258.2 | 5,784.5 | 63 |
| 100 | 3 15/16 | 600 | 360.0 | 252.00 | 360.00 | 360.00 | 504.00 | 504.00 | 720.00 | 219.0 | 5,475.0 | 6,023.0 | 61 |
| 102 | 4 | 612 | 367.2 | 261.00 | 372.90 | 372.90 | 522.05 | 522.05 | 745.75 | 227.8 | 5,696.2 | 6,266.3 | 61 |
| 105 | 4 1/8 | 630 | 378.0 | 274.75 | 392.50 | 392.50 | 549.50 | 549.50 | 785.00 | 241.4 | 6,036.2 | 6,640.4 | 59 |
| 108 | 4 1/4 | 548 | 388.8 | 288.70 | 412.45 | 412.45 | 577.40 | 577.40 | 824.85 | 255.4 | 6,386.0 | 7,025.2 | 57 |
| 111 | 4 3/8 | 666 | 399.6 | 302.90 | 432.70 | 432.70 | 605.80 | 605.80 | 865.45 | 269.8 | 6,745.7 | 7,420.9 | 55 |
| 114 | 4 1/2 | 684 | 410.4 | 317.30 | 453.30 | 453.30 | 634.60 | 634.60 | 906.60 | 284.6 | 7,115.3 | 7,827.5 | 53 |
| 117 | 4 5/8 | 702 | 421.2 | | | 474.20 | 663.85 | 663.85 | 948.35 | 299.8 | 7,494.7 | 8,244.9 | 53 |
| 120 | 4 3/4 | 720 | 432.0 | | | 495.35 | 693.50 | 693.50 | 990.70 | 315.4 | 7,884.0 | 8,673.1 | 51 |
| 122 | 4 13/16 | 732 | 439.2 | | | | | 713.50 | 1019.00 | 326.0 | 8,149.0 | 8,964.6 | 51 |

Calculation for following table

| Type | Breaking Test | Proof Test |
|---------------------|----------------------------------|---------------------------------|
| Mild Steel | 0.001d ² (44.- 0.03d) | 0.0007d ² (44-0.08d) |
| Special Steel | 0.0014d ² (44-0.08d) | 0.001d ² (44-0.08d) |
| Extra Special Steel | 0.002d ² (44-0.08d) | 0.0014d ² (44-0.08d) |

How To Order Stud Link Chain

1. Chain Diameter.
2. Length: 25m or 27.5 m
3. Quantity of "Lengths"
4. Quantity of Joining Shackles or Kenter Shackles
5. Quantity of Anchor Shackles.
6. Quantity of Swivel Pieces.
7. Certification. NK, LR, AB...etc.

Anchor Chain

SHACKLES (JIS F-3303) For Anchor Chain

(1) JIS Joining Shackle (Oval Pin)

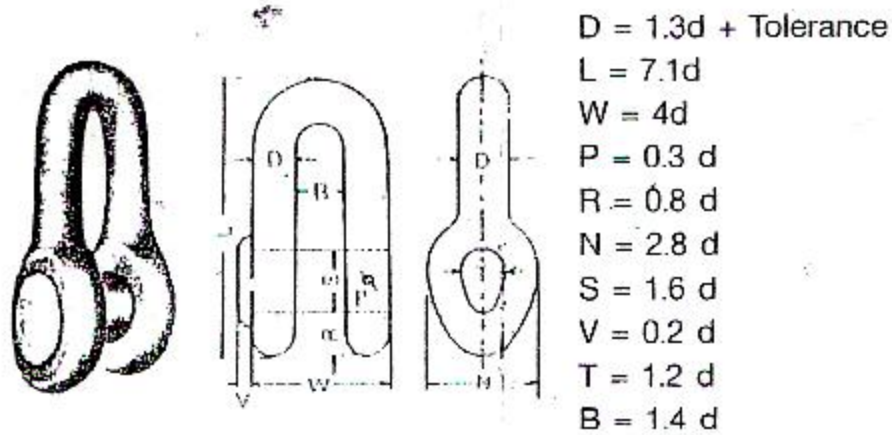

$D = 1.3d + \text{Tolerance}$
 $L = 7.1d$
 $W = 4d$
 $P = 0.3d$
 $R = 0.8d$
 $N = 2.8d$
 $S = 1.6d$
 $V = 0.2d$
 $T = 1.2d$
 $B = 1.4d$

(2) JIS Anchor Shackle (Oblong Pin)

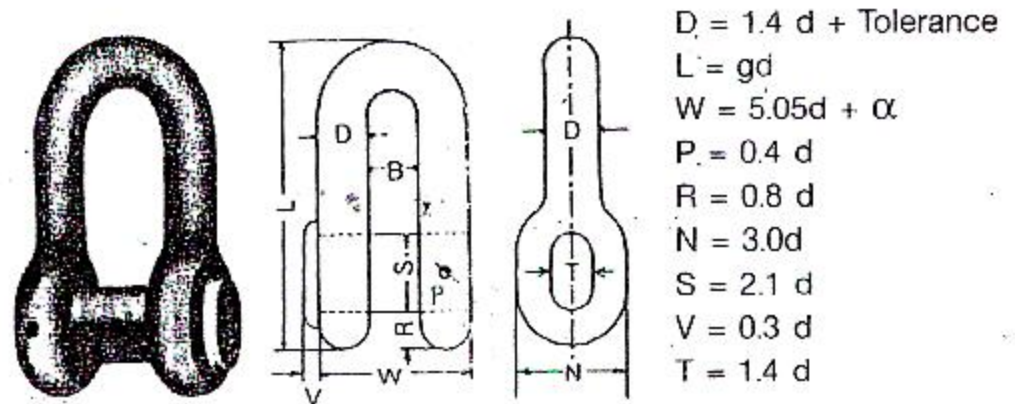

$D = 1.4d + \text{Tolerance}$
 $L = gd$
 $W = 5.05d + \alpha$
 $P = 0.4d$
 $R = 0.8d$
 $N = 3.0d$
 $S = 2.1d$
 $V = 0.3d$
 $T = 1.4d$

1. Sizes and Weights of Joining Shackle (Approx)

| Size of Chain applied (d) | | D 1.3 d | L 7.1 d | S 1.6d | W 4d | B 1.4 d | W/pce. |
|---------------------------|---------|------------|------------|-----------|---------|------------|--------|
| m/m | in | m/m | m/m | m/m | m/m | m/m | kg |
| 16 | 5/8 | 21 | 114 | 26 | 64 | 22 | 0.9 |
| 19 | 3/8 | 25 | 135 | 30 | 76 | 26 | 1.8 |
| 22 | 7/8 | 29 | 155 | 35 | 88 | 31 | 2.8 |
| 25 | 1 | 33 | 178 | 40 | 100 | 35 | 4.0 |
| 28 | 1 1/8 | 36 | 199 | 45 | 112 | 40 | 5.6 |
| 30 | 1 3/16 | 39 | 213 | 48 | 120 | 42 | 6.8 |
| 32 | 1 1/4 | 42 | 227 | 51 | 128 | 45 | 7.9 |
| 34 | 1 5/16 | 44 | 241 | 55 | 136 | 48 | 10.0 |
| 36 | 1 3/8 | 47 | 256 | 58 | 144 | 50 | 12.0 |
| 38 | 1 1/2 | 50 | 270 | 61 | 152 | 53 | 13.9 |
| 40 | 1 9/16 | 52 | 284 | 64 | 160 | 56 | 15.6 |
| 42 | 1 5/8 | 55 | 298 | 67 | 168 | 59 | 17 |
| 44 | 1 3/4 | 57 | 312 | 70 | 176 | 62 | 20 |
| 46 | 1 13/16 | 60 | 327 | 74 | 184 | 64 | 23 |
| 48 | 1 7/8 | 62 | 341 | 77 | 192 | 67 | 25 |
| 50 | 2 | 65 | 355 | 80 | 200 | 70 | 30 |
| 52 | 2 1/16 | 68 | 371 | 83 | 208 | 73 | 35 |
| 54 | 2 1/8 | 70 | 383 | 86 | 216 | 76 | 40 |
| 56 | 2 3/16 | 73 | 398 | 90 | 224 | 78 | 45 |
| 58 | 2 1/4 | 75 | 412 | 93 | 232 | 81 | 50 |
| 60 | 2 3/8 | 78 | 426 | 96 | 240 | 84 | 53 |
| 62 | 2 1/2 | 81 | 440 | 99 | 248 | 87 | 60 |
| 64 | 2 9/16 | 83 | 454 | 102 | 256 | 90 | 65 |
| 66 | 2 5/8 | 86 | 469 | 106 | 264 | 92 | 70 |
| 68 | 2 11/16 | 88 | 482 | 109 | 272 | 95 | 80 |
| 70 | 2 3/4 | 91 | 497 | 112 | 280 | 98 | 87 |
| 73 | 2 7/8 | 95 | 518 | 117 | 292 | 102 | 95 |
| 76 | 3 | 99 | 540 | 122 | 304 | 106 | 110 |
| 78 | 3 1/16 | 101 | 554 | 125 | 312 | 109 | 120 |
| 80 | 3 1/8 | 105 | 575 | 130 | 324 | 112 | 130 |
| 84 | 3 5/16 | 109 | 596 | 134 | 336 | 118 | 147 |
| 87 | 3 7/16 | 113 | 618 | 139 | 348 | 122 | 160 |
| 90 | 3 1/2 | 117 | 639 | 144 | 360 | 126 | 175 |
| 92 | 3 5/8 | 120 | 653 | 147 | 368 | 129 | 185 |
| 95 | 3 3/4 | 124 | 675 | 152 | 380 | 133 | 200 |
| 98 | 3 7/8 | 127 | 696 | 157 | 392 | 137 | 240 |
| 100 | 4 | 130 | 710 | 160 | 400 | 140 | 270 |

2. Sizes and Weights of Anchor Shackle (Approx)

| Size of Chain applied (d) | | D 1.4d | L 9d | S 2.1d | W 5.05+α | B | W/pce. |
|---------------------------|---------|-----------|---------|-----------|-------------|-----|--------|
| m/m | in | m/m | m/m | m/m | m/m | m/m | kg |
| 16 | 5/8 | 23 | 144 | 34 | 95 | 50 | 1.9 |
| 19 | 3/4 | 27 | 170 | 40 | 112 | 59 | 2.8 |
| 22 | 7/8 | 31 | 198 | 46 | 125 | 63 | 4.5 |
| 25 | 1 | 35 | 225 | 53 | 138 | 68 | 7.1 |
| 28 | 1 1/8 | 39 | 252 | 59 | 151 | 73 | 9.4 |
| 30 | 1 3/16 | 42 | 270 | 63 | 160 | 76 | 11.6 |
| 32 | 1 1/4 | 45 | 288 | 67 | 169 | 79 | 12.7 |
| 34 | 1 5/16 | 48 | 306 | 72 | 180 | 85 | 15.8 |
| 36 | 1 3/8 | 50 | 324 | 76 | 187 | 86 | 18.4 |
| 38 | 1 1/2 | 53 | 342 | 80 | 196 | 90 | 21.4 |
| 40 | 1 9/16 | 56 | 360 | 84 | 210 | 98 | 25.1 |
| 42 | 1 5/8 | 59 | 378 | 88 | 212 | 101 | 30 |
| 44 | 1 3/4 | 62 | 396 | 92 | 222 | 103 | 35 |
| 46 | 1 13/16 | 64 | 414 | 97 | 232 | 107 | 40 |
| 48 | 1 7/8 | 67 | 432 | 101 | 242 | 110 | 45 |
| 50 | 2 | 70 | 450 | 105 | 252 | 115 | 55 |
| 52 | 2 1/16 | 73 | 468 | 109 | 262 | 118 | 60 |
| 54 | 2 1/8 | 76 | 486 | 113 | 273 | 122 | 65 |
| 56 | 2 3/16 | 78 | 504 | 118 | 283 | 127 | 70 |
| 58 | 2 1/4 | 81 | 522 | 122 | 293 | 131 | 80 |
| 60 | 2 3/8 | 84 | 540 | 126 | 303 | 135 | 90 |
| 62 | 2 1/2 | 87 | 558 | 130 | 314 | 140 | 100 |
| 64 | 2 9/16 | 90 | 576 | 134 | 324 | 141 | 115 |
| 66 | 2 5/8 | 92 | 594 | 139 | 334 | 149 | 130 |
| 68 | 2 11/16 | 95 | 612 | 143 | 344 | 153 | 140 |
| 70 | 2 3/4 | 98 | 630 | 147 | 354 | 158 | 150 |
| 73 | 2 7/8 | 102 | 657 | 153 | 369 | 165 | 165 |
| 76 | 3 | 106 | 684 | 160 | 382 | 171 | 185 |
| 78 | 3 1/16 | 109 | 702 | 164 | 394 | 176 | 200 |
| 80 | 3 1/8 | 113 | 729 | 170 | 410 | 180 | 220 |
| 84 | 3 5/16 | 118 | 756 | 176 | 424 | 188 | 245 |
| 87 | 3 7/16 | 122 | 783 | 183 | 439 | 195 | 270 |
| 90 | 3 1/2 | 126 | 810 | 189 | 455 | 203 | 295 |
| 92 | 3 5/8 | 129 | 828 | 193 | 465 | 207 | 320 |
| 95 | 3 3/4 | 133 | 855 | 200 | 480 | 214 | 350 |
| 98 | 3 7/8 | 137 | 882 | 206 | 495 | 221 | 400 |
| 100 | 4 | 140 | 900 | 210 | 505 | 225 | 450 |

(5) Kenter Shackle (6) Detachable Link

(3) Swivel Piece



(7) Swivel

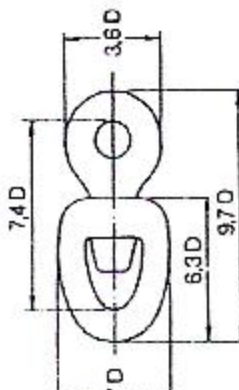

(4) Swivel Piece with Kenter Shackle



(8) Buoy Shackle A Type

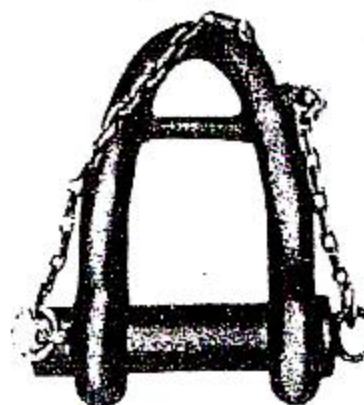

(9) Buoy Shackle B Type

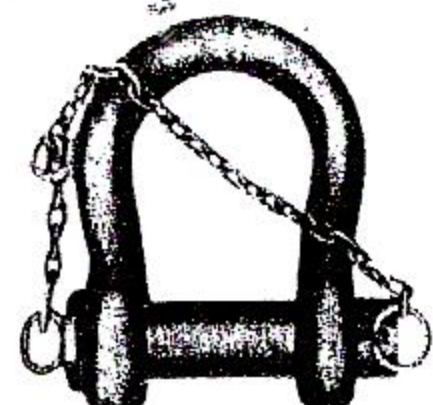

Stud Link Anchor Chain Cables

Flush Butt Welded

(Ref. JIS F 3303-1993)

Cadenas con Cartrete / Soldadas Eléctrica

フラッシュバット溶接アンカーチェーン 錨鏈

The specifications of these flush butt welded Anchor Chain Cables and their accessories for ship and harbour use are as follows.



| | |
|-------------------------------------|--|
| Nominal Size | Denoted by the diameter "d" shown in the sketch. |
| One Length | One length of the chain is 25 or 27.5 mtrs between the farther point end of the inner side of the end link and that of the opposite end link. May be also including the joining shackle and kenter shackle. |
| Nos. of Link | The total number of links for each length is odd except where it includes a swivel. |
| Shape & Size of Link, Shackle, etc. | The shape of each link, shackle and swivel must be determined in proportion to the size as shown in the sketches. They must be uniform in shape, and those next to each other must fit properly and move freely. |

Specification

| Kind of Chain | Symbol | Material |
|-----------------|--------------|---------------------------------|
| | | SBC 300 : Steel bars for chains |
| | | SS-400 : Rolled steel got |
| Stud Link Chain | Class 1 ST 1 | general structure |
| | | S20C : Cold rolled special |

| | | | steel strip |
|--|---------|------|------------------------------------|
| | Class 2 | ST 2 | SBC 490 : Steel bars for structure |
| | Class 3 | ST 3 | SBC 690 : Steel bars for structure |

Common link

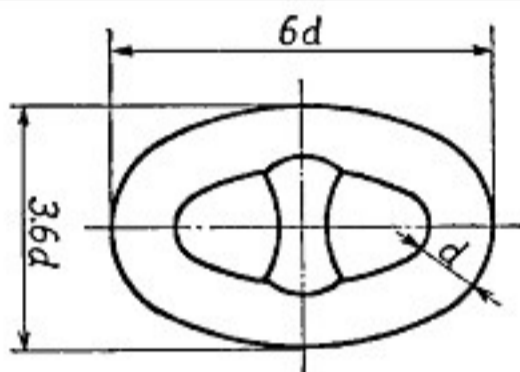

Enlarged link

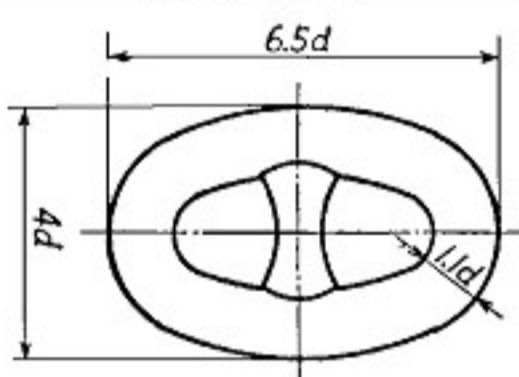

End link

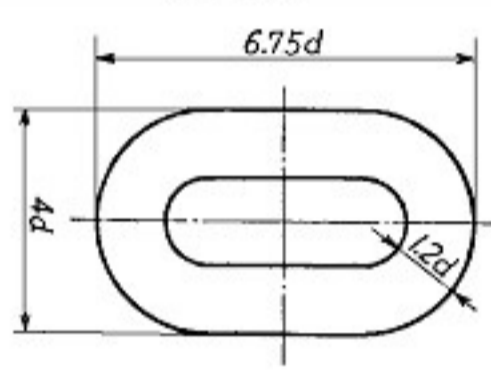

Swivel



| Chain Dia (d) | Outside Length of Common Link (6d) | Outside Width of Common Link (3.6d) | Class II | | Class III | |
|---------------|------------------------------------|-------------------------------------|-----------------|--------------------|-----------------|--------------------|
| | | | Proof Test Load | Breaking Test Load | Proof Test Load | Breaking Test Load |
| mm | mm | mm | kN | kN | kN | kN |
| 28 | 168 | 100.8 | 321 | 449 | 449 | 642 |
| 30 | 180 | 108.0 | 368 | 514 | 514 | 735 |
| 32 | 192 | 115.2 | 417 | 583 | 583 | 833 |
| 34 | 204 | 122.4 | 468 | 655 | 655 | 937 |
| 36 | 216 | 129.6 | 523 | 732 | 732 | 1,050 |
| 38 | 228 | 136.8 | 581 | 812 | 812 | 1,160 |
| 40 | 240 | 144.0 | 640 | 896 | 896 | 1,280 |
| 42 | 252 | 151.2 | 703 | 981 | 981 | 1,400 |
| 44 | 264 | 158.4 | 769 | 1,080 | 1,080 | 1,540 |
| 46 | 276 | 165.6 | 837 | 1,170 | 1,170 | 1,680 |
| 48 | 288 | 172.8 | 908 | 1,270 | 1,270 | 1,810 |
| 50 | 300 | 180.0 | 981 | 1,370 | 1,370 | 1,950 |
| 52 | 312 | 187.2 | 1,060 | 1,480 | 1,480 | 2,110 |
| 54 | 324 | 194.4 | 1,140 | 1,590 | 1,590 | 2,270 |
| 56 | 336 | 201.6 | 1,220 | 1,710 | 1,710 | 2,430 |
| 58 | 348 | 208.8 | 1,290 | 1,810 | 1,810 | 2,600 |
| 60 | 360 | 216.0 | 1,380 | 1,940 | 1,940 | 2,770 |
| 62 | 372 | 223.2 | 1,470 | 2,060 | 2,060 | 2,940 |
| 64 | 384 | 230.4 | 1,560 | 2,190 | 2,190 | 3,130 |
| 66 | 396 | 237.6 | 1,660 | 2,310 | 2,310 | 3,300 |
| 68 | 408 | 244.8 | 1,750 | 2,450 | 2,450 | 3,500 |
| 70 | 420 | 252.0 | 1,840 | 2,580 | 2,580 | 3,690 |
| 73 | 438 | 262.8 | 1,990 | 2,790 | 2,790 | 3,990 |
| 76 | 456 | 273.6 | 2,150 | 3,010 | 3,010 | 4,300 |
| 78 | 468 | 280.8 | 2,260 | 3,160 | 3,160 | 4,500 |
| 81 | 486 | 291.6 | 2,410 | 3,380 | 3,380 | 4,820 |
| 84 | 504 | 302.4 | 2,580 | 3,610 | 3,610 | 5,160 |
| 87 | 522 | 313.2 | 2,750 | 3,850 | 3,850 | 5,500 |

Remark : Larger or smaller sizes than the above list are also available.

Joining with Joining Shackle

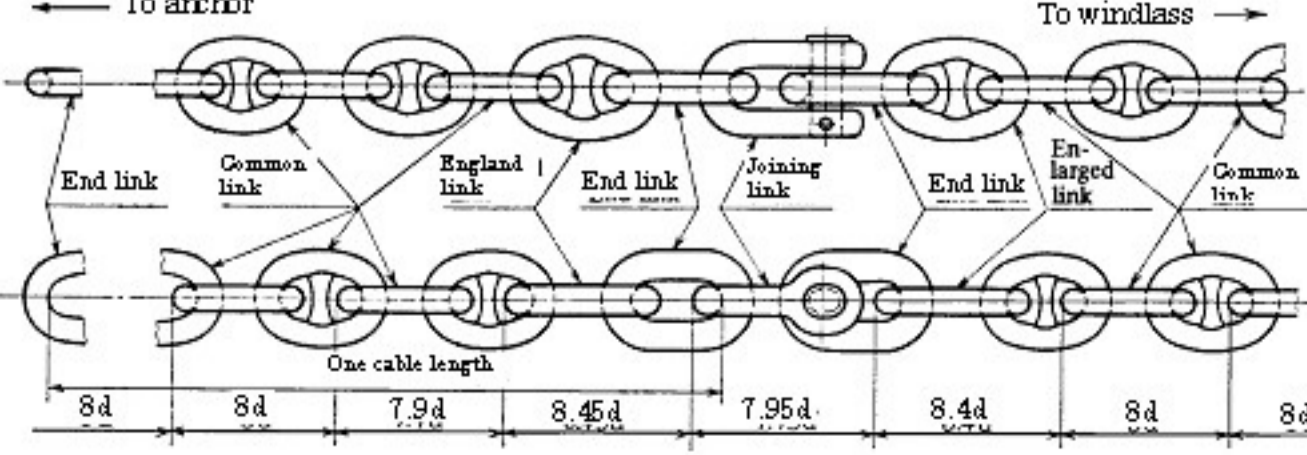

Kenter Shackles

Grilletes de Tipo Kenter

ケンターシャックル Kenter 接圈

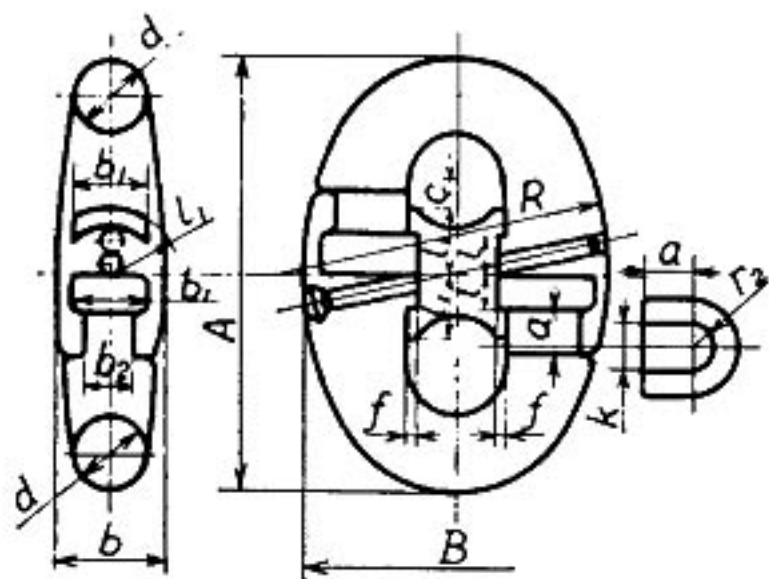

Dimension

Unit:mm

| A | B | a | b | b ₁ | b ₂ | C |
|--------|-------|-------|-------------------|----------------|----------------|-------------------|
| 6d | 4.2d | 0.67d | 1.52d | 1.1d | 0.73d | Approx. 0.415d |
| f | k | l | l ₁ | | R | r ₂ |
| 0.106d | 0.73d | 0.5d | Approx. 0.915d | | 4.4d | 0.36d |

Remark: "d" is the nominal diameter of the chain.

How to order : 23 - 11 -

Kenter shackle for diam. mm(d) stud link anchor chain cable, (class of chain) with certificate

Joining Shackles

Grilletes de Unión

ジョイニングシャックル 接続用接圈

$D = 1.3d + \text{Tolerance}$

$L = 7.1d$

$W = 4d$

$P = 0.3d$

$R = 0.8d$

$N = 2.8d$

$S = 1.6d$

$V = 0.2d$

$T = 1.2d$

$B = 1.4d$

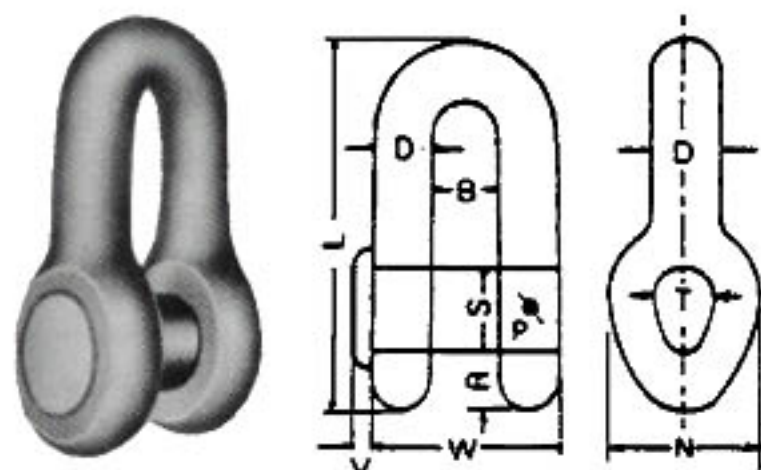

| Size of Chain Applied (d) | | D | L | S | W | B | Weight /pce |
|---------------------------|---------|-------------|-------------|-------------|-----------|-------------|-------------|
| m/m | in | 1.3d m/m | 7.1d m/m | 1.6d m/m | 4d m/m | 1.4d m/m | kg |
| 28 | 1-1/8 | 36 | 199 | 45 | 112 | 39 | 5.6 |
| 30 | 1-3/16 | 39 | 213 | 48 | 120 | 42 | 6.8 |
| 32 | 1-1/4 | 42 | 227 | 51 | 128 | 45 | 7.9 |
| 34 | 1-5/16 | 44 | 241 | 54 | 136 | 48 | 10.0 |
| 36 | 1-3/8 | 47 | 256 | 58 | 144 | 50 | 12.0 |
| 38 | 1-1/2 | 49 | 270 | 61 | 152 | 53 | 13.9 |
| 40 | 1-9/16 | 52 | 284 | 64 | 160 | 56 | 15.6 |
| 42 | 1-5/8 | 55 | 298 | 67 | 168 | 59 | 17 |
| 44 | 1-3/4 | 57 | 312 | 70 | 176 | 62 | 20 |
| 46 | 1-13/16 | 60 | 327 | 74 | 184 | 64 | 23 |
| 48 | 1-7/8 | 62 | 341 | 77 | 192 | 67 | 25 |
| 50 | 2 | 65 | 355 | 80 | 200 | 70 | 30 |
| 52 | 2-1/16 | 68 | 370 | 83 | 208 | 73 | 35 |
| 54 | 2-1/8 | 70 | 383 | 86 | 216 | 76 | 40 |
| 56 | 2-3/16 | 73 | 398 | 90 | 224 | 78 | 45 |
| 58 | 2-1/4 | 75 | 412 | 93 | 232 | 81 | 50 |
| 60 | 2-3/8 | 78 | 426 | 96 | 240 | 84 | 53 |
| 62 | 2-1/2 | 81 | 440 | 99 | 248 | 87 | 60 |
| 64 | 2-9/16 | 83 | 454 | 102 | 256 | 90 | 65 |
| 66 | 2-5/8 | 86 | 469 | 106 | 264 | 92 | 70 |
| 68 | 2-11/16 | 88 | 483 | 109 | 272 | 95 | 80 |
| 70 | 2-3/4 | 91 | 497 | 112 | 280 | 98 | 87 |
| 73 | 2-7/8 | 95 | 518 | 117 | 292 | 102 | 95 |
| 76 | 3 | 99 | 540 | 122 | 304 | 106 | 110 |
| 78 | 3-1/16 | 101 | 554 | 125 | 312 | 109 | 120 |
| 81 | 3-3/16 | 105 | 575 | 130 | 324 | 113 | 130 |
| 84 | 3-5/16 | 109 | 596 | 134 | 336 | 118 | 147 |
| 87 | 3-7/16 | 113 | 618 | 139 | 348 | 122 | 160 |

Remark: Shackles of sizes other than those listed above are also available upon request.

How to order : 23 - 11 -

Joining shackle for 28(d) mm stud link anchor chain cable, ST2 with certificate

Note: When ordering, be sure to state the size of the anchor chain for which these shackles are to be used. These shackles are proof and break tested to the same specification loads as the anchor chain with which they are used.